

Translation of the  
ORIGINAL INSTRUCTION BOOK

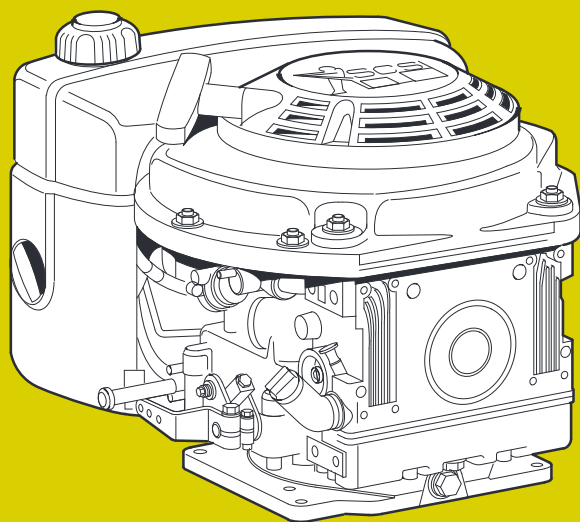

1B 20V  
1B 30V  
1B 40V  
1B 40W  
1B 50V  
1B 50W

000043380277-ENG-01.11-0.1  
Printed in Germany



## A new HATZ Diesel engine - working for you

This engine is intended only for the purpose determined and tested by the manufacturer of the equipment in which it is installed. Using it in any other manner contravenes the intended purpose. For danger and damage due to this, Motorenfabrik HATZ assumes no liability. The risk is with the user only.

Use of this engine in the intended manner presupposes compliance with the maintenance and repair instructions laid down for it. Noncompliance leads to engine breakdown.

Please do not fail to read this operating manual before starting the engine. This will help you to avoid accidents, ensure that you operate the engine correctly and assist you in complying with the maintenance intervals in order to ensure long-lasting, reliable performance.

Please pass this Instruction Manual on to the next user or to the following engine owner.



---

Always have service work performed by qualified specialists. To this effect, we recommend that you consult one of the 500 HATZ service stations. There, your engine is repaired by staff who constantly undergo training and who use both original HATZ spare parts and HATZ tools. The world-wide HATZ service network is also available to you for consultation and spare parts supply.

For the address of your nearest HATZ service station, please refer to the attached list or the internet under: [www.hatz-diesel.com](http://www.hatz-diesel.com)



### Original-Ersatzteile

Original-spare parts

Pièces de rechange d'origine

Repuestos originales

---

The installation of inappropriate spare parts may cause problems. We cannot accept any liability for damage or consequential damage resulting therefrom.

Thus, we recommend that you use original HATZ spare parts. These parts are manufactured following the strict HATZ specifications and ensure, thanks to their perfect fit and function, maximum operating reliability. For the reference number, please consult the attached spare part list or the internet under: [www.hatz-diesel.com](http://www.hatz-diesel.com). Please take the complete spare parts kits in Table M00 into account.

We reserve the right to make modifications in the course of technical progress.

MOTORENFABRIK HATZ GMBH & CO KG

# Contents

	Page		Page
1. Important safety notes when operating the engine	3	5.3. Maintenance every 250 operating hours	19
2. Description of the engine	5	5.3.1. Changing engine oil	19
3. General notes	6	5.3.2. Checking and adjusting valve clearances	19
3.1. Technical data	6	5.3.3. Cleaning the air cleaner zone	21
3.2. Transport	7	5.3.4. Checking screw connections	21
3.3. Notes on installation	7	5.3.5. Cleaning the exhaust mesh inlet	21
3.4. Load on engine	7	5.4. Maintenance every 500 operating hours	23
3.5. Type plate	7	5.4.1. Renewing fuel filter	23
4. Operation	8	5.4.2. Air cleaner maintenance	23
4.1. Prior to first-time start-up	8	5.5. Maintenance every 1000 operating hours	25
4.1.1. Engine oil	8	5.5.1. Cleaning the oil filter	25
4.1.2. Fuel	9	5.6. Servicing: once a year	27
4.2. Starting	10	5.6.1. Draining the fuel tank	27
4.2.1. Preparations for starting	10	6. Malfunctions – causes – remedies	28
4.2.2. Recoil start for versions <u>without</u> electric starter	11	7. Work on the electrical system	32
4.2.3. Recoil start for versions <u>with</u> electric starter	12	8. Storage out of use	32
4.2.4. Electric starter	12	Declaration for Incorporation	33
4.3. Stopping the engine	14		
5. Maintenance	16		
5.1. Maintenance chart	16		
5.2. Maintenance every 8 – 15 operating hours	18		
5.2.1. Checking engine oil level	18		
5.2.2. Check air intake area for combustion and cooling	18		
5.2.3. Check air cleaner maintenance indicator	18		



This symbol identifies important safety precautions. Please comply with these most carefully in order to avoid any risk of injury to persons or damage to materials. General legal requirements and safety regulations issued by the competent authorities or industrial accident insurers must also be complied with.

## 1. Important safety notes when operating the engine



HATZ diesel engines are efficient, strong and durable. For this reason they are frequently installed on equipment used for commercial purposes.

The manufacturers of such equipment must observe any relevant equipment safety regulations when the engine forms part of an overall system.

A few general points concerning operating safety should none the less be noted.

Depending on the engine's operating and installation conditions, equipment manufacturers and their users may have to fit safety or protective devices in order to prevent improper use. Examples:

- Exhaust system components as well as the surface of the engine will naturally be hot and must not be touched while the engine is running or until it has cooled down after being stopped.
- Incorrect wiring or improper operation of the electrical system may cause sparking and must therefore be avoided.
- Provide protection against contact with rotating parts once the engine is connected to the driven equipment or machine.  
HATZ protective guards are available for the belt drive of the cooling fan and alternator drive systems.
- Always observe the start-up information in the operating instructions before starting the engine: this is particularly important when starting an engine with the recoil starter!
- Mechanical starting devices should not be operated by children or persons deficient in physical strength.
- Check that all safety devices are in place before starting the engine.
- Ensure that operation, maintenance and repair of the engine are undertaken by suitably trained personnel only.
- Protect the starter key against unauthorised use.
- Do not run the engine in closed or badly ventilated rooms.  
Do not breath in emissions – danger of poisoning!
- Also fuel and lubricants could contain poisonous components. Please follow the instructions of the mineral oil producer (safety data sheets).

## Important safety notes when operating the engine



- The engine must be stopped before performing any maintenance, cleaning- or repair work.
- Stop the engine before refilling the fuel tank.  
Never refuel near a naked flame or sparks which could start a fire. Don't smoke. Don't spill fuel.
- Keep explosive materials as well as flammable materials away from the engine because the exhaust gets very hot during operation.
- Wear close-fitting clothing when working on the engine while it is running.  
Please don't wear necklaces, bracelets or any other things which you could get caught with.
- Please pay attention to all advice- and warning stickers placed on the engine and keep them in legible condition. In case a label has come off or is no longer clearly legible, it must be replaced immediately. To this effect, please contact the HATZ service station in your area.
- We accept no liability for damage resulting from improper modifications to the engine.

Regular maintenance in accordance with the details given in these operating instructions is essential to keep the engine in good working order.

When in doubt, consult your local HATZ service station before starting the engine.

## 2. Description of the engine

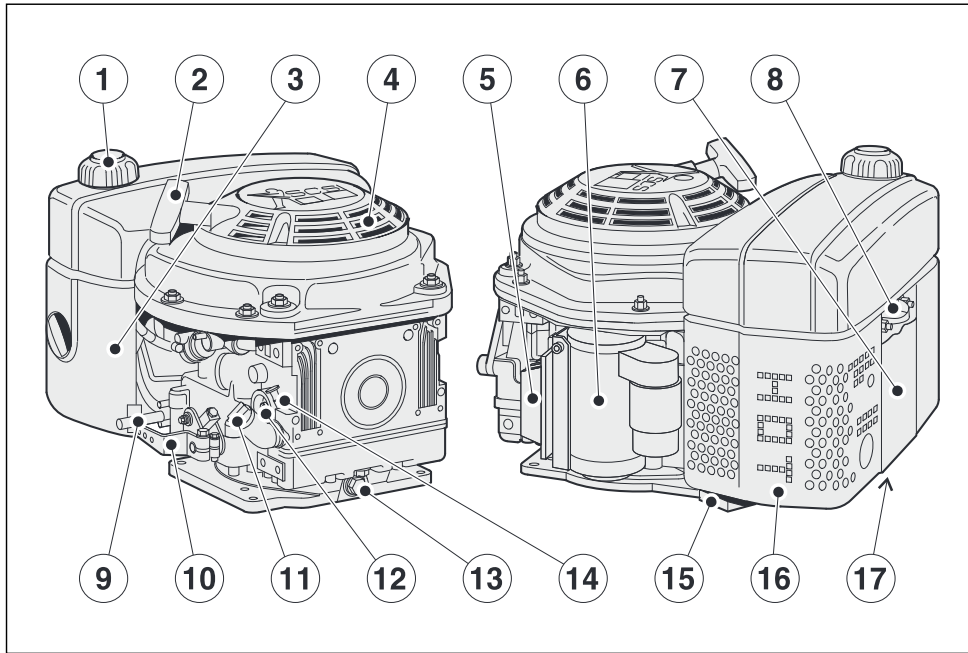

Fig 1

- |  |                        |
|--|------------------------|
| 1 Fuel tank cap                                    | 9 Engine shutdown pin  |
| 2 Recoil starter                                   | 10 Speed control lever |
| 3 Dry-type air cleaner                             | 11 Oil filler pipe     |
| 4 Intake opening for cooling and<br>combustion air | 12 Oil filter          |
| 5 Voltage regulator                                | 13 Oil drain plug      |
| 6 Starter motor                                    | 14 Dipstick            |
| 7 Noise insulating hood                            | 15 Exhaust mesh insert |
| 8 Lifting lug                                      | 16 Exhaust silencer    |
|  | 17 Type plate          |

### 3. General notes

#### 3.1. Technical data

Type		1B20 V	1B30 V	1B40 V/W	1B50 V/W
Design		Air-cooled four-stroke diesel engine			
Combustion system		Direct injection			
Number of cylinders		1	1	1	1
Bore/stroke	mm	69 / 65	80 / 69	88 / 76	93 / 76
Displacement	cm <sup>3</sup>	243	347	462	517
Lubricating oil capacity	l, approx.	0.9 <sup>1)</sup>	1.1 <sup>1)</sup>	1.5 <sup>1)</sup>	1.5 <sup>1)</sup>
Difference between „max.“ and „min.“ levels	l, approx.	0.5 <sup>1)</sup>	0.5 <sup>1)</sup>	0.8 <sup>1)</sup>	0.8 <sup>1)</sup>
Lubricating oil consumption after a running-in period	max.	1 % of fuel consumption at full load			
Lubricating oil pressure (oil temperature 100 °C)	approx.	2.5 bar at 3000 r.p.m.			
Direction of rotation, power take-off end		counterclockwise			
Valve clearance 10 - 30 °C Inlet and exhaust valve	mm	0.20	0.10	0.10	0.10
		or automatically <sup>2)</sup>			
Max. angle from vertical in any direction (continuous operation)		25° <sup>3)</sup>			
Weight (incl. fuel tank, air-cleaner, exhaust silencer, recoil starter and electric starter)	kg approx.	35	42	1B40 V : 55 1B40 W: 57	1B50 V : 56 1B50 W: 58
Battery capacity	min / max	12 V - 36 / 60 Ah □ 24 V - 24 / 44 Ah			

<sup>1)</sup> These values are intended as an approximate guide. The max. marking on the dipstick is the determining factor, Fig. 7.

<sup>2)</sup> Depending on model (see maintenance charts, chapter 5.1)

<sup>3)</sup> Exceeding these limits causes engine breakdown.

#### Tightening torques

Item	Nm
Oil drain plug	50



3.2. Transport

 A suspension lug „8“ is provided as standard equipment, so that the engine can be lifted safely, chap. 2. It is not suitable or approved for lifting the complete equipment to which the engine is attached.

3.3. Notes on installation

If you have an engine which is not yet installed in a machine and still has to be installed, make sure that the Assembly Instructions for HATZ Diesel Engines are complied with prior to installation. These Assembly Instructions contain important information about safe assembly of the engine and are available from your the HATZ service center in your area.  
Pending complete installation, the engine must not be started!  
Moreover, we would like to point out that in this case, commissioning of the machine is also prohibited until it has been verified that the machine into which this engine is to be incorporated complies with all the safety precautions and regulations provided by law.  
Refer also to the Declaration for Incorporation at the end of these Operating Instructions.

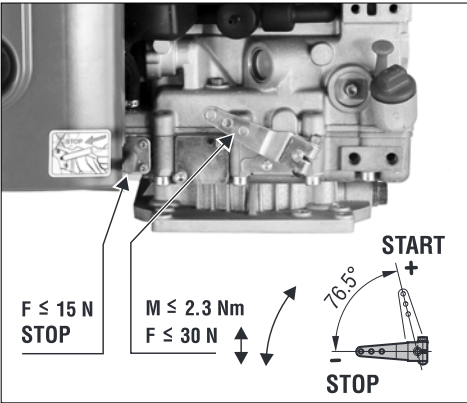

2

 The permitted loads and elements on the speed adjusting lever and the engine shutdown pin should be observed as an excess can lead to damage to the contacts and inner governor parts, Fig. 2.

3.4. Load on engine

Operating the engine for a lengthy period off-load or at very low loads can affect its running quality. We therefore recommend a minimum engine load of 15 %. If operated at such low loads, it is best to operate the engine at a significantly higher load for a short period before switching it off.

3.5. Type plate

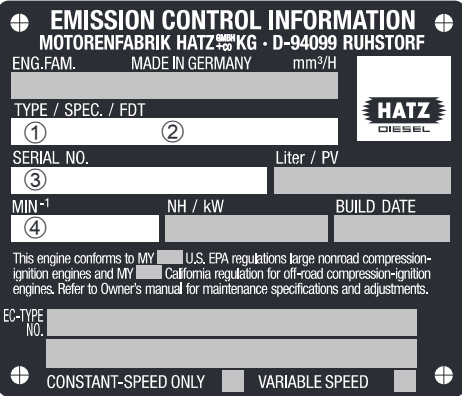

3

The type plate is placed on the noise insulating hood (Fig. 1) and includes the following engine information:

- ① engine type
- ② code (only for special equipment)
- ③ engine number (also stamped on crankcase, Fig. 4)
- ④ max. engine speed.

For any offer as well as spare parts orders it is necessary to mention these data (also see spare parts list, page 1).

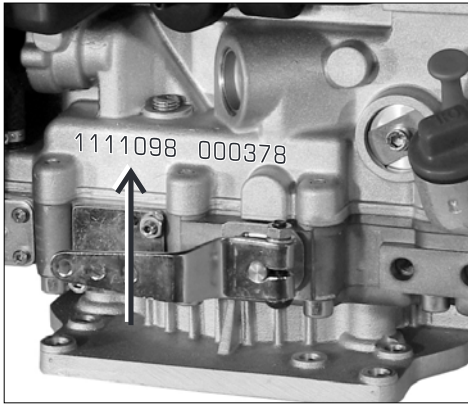

4

Engine serial number on crankcase.

## 4. Operation

### 4.1. Before starting up for the first time

Engines are normally supplied dry, i.e. not containing fuel or oil.

#### 4.1.1. Engine oil

##### Oil quality

Qualified are all trademark oils which fulfil at least one of the following specifications:

ACEA – B2 / E2 or more significant

API – CD / CE / CF / CF-4 / CG-4 or more significant.

If engine oil of a poorer quality is used, reduce oil change intervals to 150 hours of operation.

##### Oil viscosity

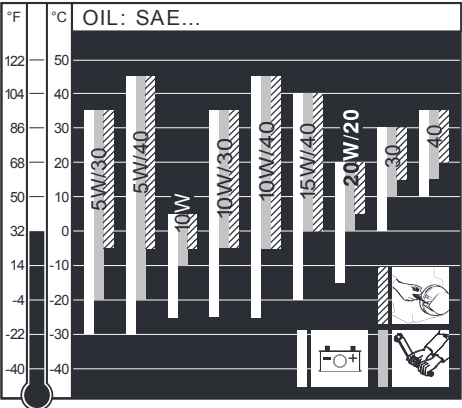

5

Please select the recommended viscosity depending on the ambient temperature at which the engine is operated.

Inappropriate engine oil may shorten the engine's service life significantly.

When adding oil or checking the oil level, the engine must be horizontal.

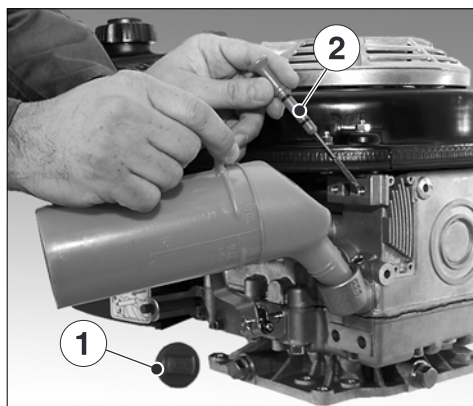

6

- Remove oil filler screw „1“ and dipstick „2“.

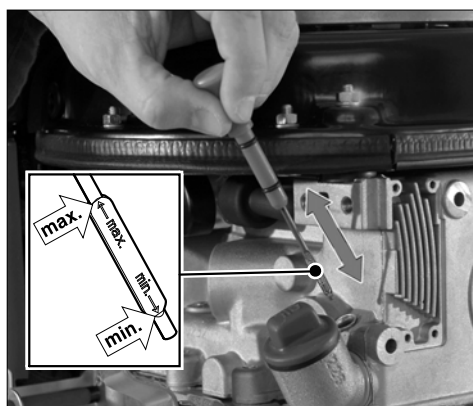

7

- Add engine oil up to the MAX mark on dipstick.  
Lubricating oil capacity: see Chapter 3.1.
- Insert the oil filler screw and tighten it (hand-tight only).

#### Attention!

If the engine is operated while the oil level is below the min. mark or above the max. mark, it can cause damage to the engine.

### 4.1.2. Fuel



Stop the engine before refilling the fuel tank. Never refuel near a naked flame or sparks which could start a fire. Don't smoke. Use only pure fuel and clean filling equipment. Take care not to spill fuel.

All diesel oils which satisfy the following specifications are suitable:

EN 590 or  
BS 2869 A1 / A2 or  
ASTM D 975 -1D / 2D

#### Important!

The use of fuels of different specifications requires the prior written consent of the HATZ headquarters.



8

- Before the first start or if the fuel tank has been run dry, completely fill the fuel tank with diesel. The bleeding of the fuel system is automatically.

At temperatures below 0 °C, winter-grade fuel should be used or paraffin added to the fuel well in advance.

Lowest ambient temperature when starting, in °C	Paraffin content for:	
	Summer fuel	Winter fuel
0 up to -10	20 %	–
-10 up to -15	30 %	–
-15 up to -20	50 %	20 %
-20 up to -30	–	50 %

4.2. Starting

 Do not run the engine in closed or badly ventilated rooms – danger of poisoning! Before starting the engine, ensure that no-one is in the danger area close to the engine or equipment, and that all protective guards are fitted.

4.2.1. Preparations for starting

If possible, disengage the engine from any driven equipment.  
The auxiliary equipment should always be placed in neutral.

Recoil starter

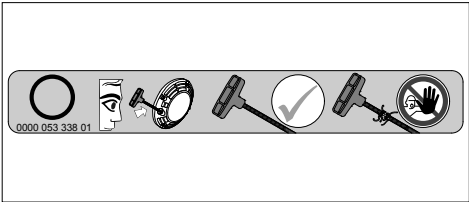

9

 Check the starter rope for chafing and, if necessary, replace it.  
A damaged rope may break during starting, and cause injury.

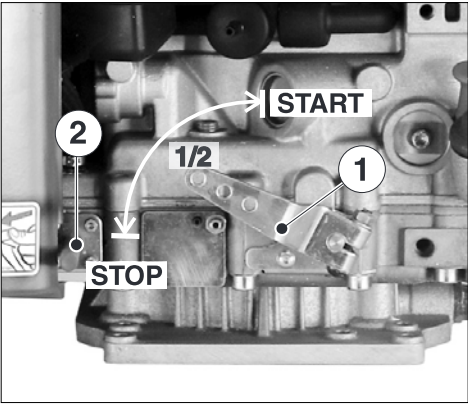

10

- Set speed control lever „1“; First of all put the lever in STOP-position and then either to 1/2 START or max. START position, as desired or necessary.  
Starting at a lower speed will help to prevent exhaust smoke.
- Now, the engine is ready for starting.

Important !  
After long-time standstill (approx. 6 months or even longer) or first operation, operate engine with low adjusted speed and without load for approx. 20 sec. after start. This measure assures a lubrication of all bearings before increasing speed and load.  
It also prevents an insufficient lubrication.

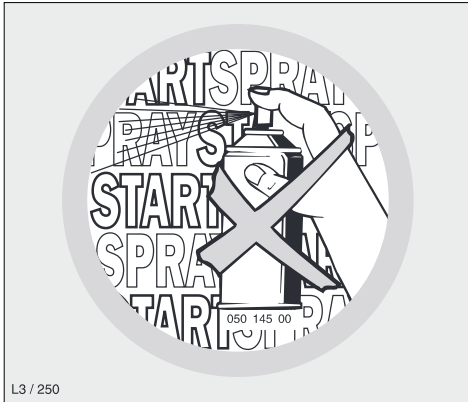

11



Never use starting sprays !

#### 4.2.2. Recoil start for versions without electric starter (till -6 °C)

– For starting preparations, see Chapter 4.2.1.

##### Starting procedure

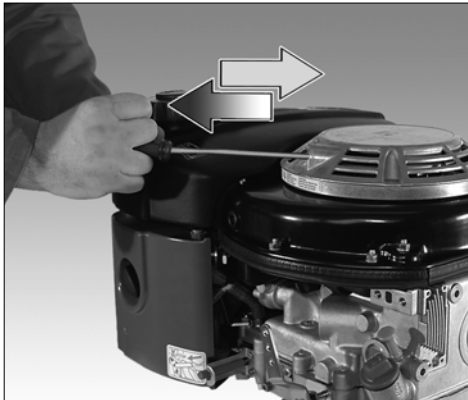

12

– Pull the starting cable out by the handle until you feel a slight resistance.

- Let the cable run back; in this way the entire length of the starting cable can be used to start the engine.
- Devices which are not securely fastened should be restrained with the foot.



13

– Grip the handle with both hands.



14

– Commence pulling the starting cable vigorously and at an increasing speed (do not jerk it violently) until the engine starts.

Note:

If after several attempts of starting the exhaust begins to emit white smoke, move the speed control lever to the STOP position and pull the starting cable out slowly 5 times. Repeat the starting procedure, Chapter 4.2.1.

#### 4.2.3. Recoil start for versions with electric starter (till -6°C)

The recoil starter at engines with electric start is an emergency starting device without decompression automatic.

Therefore, attention has to be paid to the exact starting procedure as mentioned below.

- Prepare the engine for starting; see Chapter 4.2.1.
- Pull out the handle with the cord slowly until compression resistance is clearly felt; Fig. 12.
- Continue to pull slowly but with greater force until the resistance becomes noticeably less (compression overcome).
- Now let the cord run back - the engine is in the correct starting position.

In this way the engine can be accelerated through about one and a half revolutions with the starting cord, to overcome compression resistance and achieved the required momentum for starting.

- Support equipment with the foot if it is too light in weight or liable to tip over.
- Take hold of the handle with both hands; Fig. 13.
- Pull the starting cord up forcefully and at an increasing speed (but do not jerk it) - the engine should then start; Fig. 14.

Note:

In the case of engines with automatic electrical shutdown system (see next chapter), first actuate the starter switch from position 0 to position I, then perform a recoil start within the following 12 seconds. If the engine does not run after 12 seconds, this means that the electrical system blocks the fuel supply to the injection pump.

In this case, the engine cannot be started.

As a solution, turn the starter key back to position 0, then turn it to position I again. Now, start the engine within the following 12 seconds.

#### 4.2.4. Electric starter

- For starting preparations, see Chapter 4.2.1.

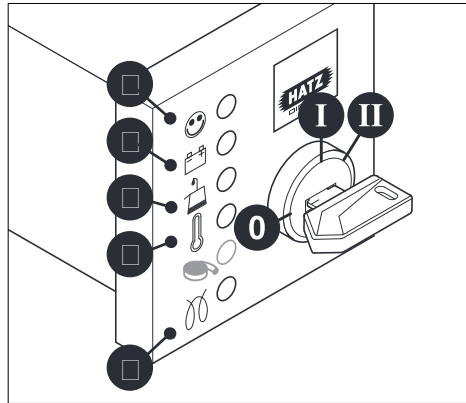

15

- Insert the key to its stop and turn it to position I.
- Battery charge telltale „2“ and oil pressure warning „3“ must light up.
- Turn start key to position II.
- As soon as the engine runs, release the start key. It must return to position I by itself and remain in this position during operation.

- The battery charge telltale and oil pressure warning must go out immediately after starting. Indicator light „1“ is on when the engine is in operation; Fig. 15.
- The engine temperature display „4“ (additional equipment) lights up if the temperature at the cylinder head becomes too high. Switch off the engine and trace and eliminate the cause of the problem, chap. 6.
- Always turn the start key back to position 0 before re-starting the engine. The repeat lock in the ignition lock prevents the starter motor from engaging and possibly being damaged while the engine is still running.

**Note:**

Start for max. 30 seconds. If the engine does not run after this time, turn starter key back to position 0 and eliminate the cause, Chapter 6.

Preheating device with automatic heating timer (additional equipment)

The preheating light „5“ lights up additionally at temperatures below 0° Celsius (Fig. 15).

- After the light has gone out, start the engine without delay.

### Fuel shut-off valve, stop solenoid (additional equipment)

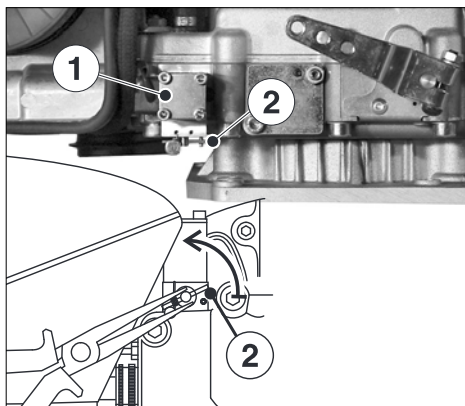

16

As soon as the starting key is at Position I, fuel shut-off valve „1“ is electrically released. The fuel feed to the injection pump is then open and the engine is ready to start.

When the engine is running, turning the starting key to position 0 closes the shut-off valve and interrupts the fuel supply to the injection pump, so that the engine stops; Chapter 4.3.

This shut-off valve is also used for the automatic electrical shutdown system.

### Emergency start

If the shut-off valve is blocking the fuel supply as a result of an electrical fault and the engine therefore cannot be started, an emergency start can be attempted.

Proceed as follows for this:

- For emergency starting, turn the lever at fuel shut-off solenoid „2“ anti-clockwise by at least 90° using suitable pliers. The lead seal wire will break off.; Fig. 16.



- As soon as the emergency start lever is in the starting position, the electric starter or recoil starter can be used; Chapter 4.2.2 and 4.2.3. The oil level must always be checked before an emergency start, as insufficient oil pressure can lead to complete damage of the engine within a very short time.



After this, the engine can only be stopped with the starting key in the emergency operating mode if the emergency starting lever is first turned back clockwise to the stop position.

Immediately after a period of emergency running, ascertain the cause of the fault and have it rectified; Chapter 6. Have the emergency-starting lever sealed once again by a HATZ service point. When the automatic electrical shutdown system is used, the emergency start described above means that liability for risks must be accepted by the operator (Motorenfabrik HATZ assumes no liability)! In case of difficulty contact the nearest HATZ service point.

#### Automatic electrical shutdown system (additional equipment)

This is characterized by a brief flashing of all pilot lamps once the starter key has been turned to position I (Fig. 15).

#### Important!

If the engine cuts out immediately after starting or switches off by itself during operation, a monitoring element in the automatic shutdown system has tripped. The corresponding indicator light (Fig. 14, positions 2 - 4) will come on. After the engine has stopped, the display continues to glow for about 2 minutes.

The electrical device then switches itself off automatically.

The display lights up again after the start key has been turned back to position 0 and then to position I again.

Trace and eliminate the cause of the operating fault before trying to restart the engine (see chapter 6.2.).

The display light goes out when the engine is next started.

Even with automatic shutdown monitoring the oil level must be checked every 8 – 15 operating hours (Chapter 5.2.1.).

#### 4.3. Stopping the engine

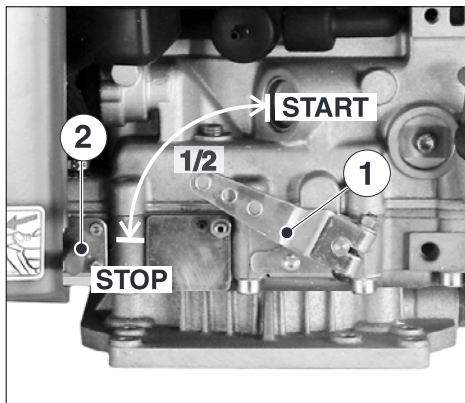

17

- Move the speed adjustment lever „1“ back to the STOP position. The engine cuts out.



**Note:**

Engines with a fixed lower idling speed cannot be switched off using the speed adjustment lever. See the paragraph entitled „Other ways of switching off the engine“.

**Other ways of switching off the engine**

1. Fuel shut-off valve, stop solenoid (optional extra)

– Turn ignition key to the 0 position. The engine cuts out, Fig. 19.

2. Stop pin (optional extra)

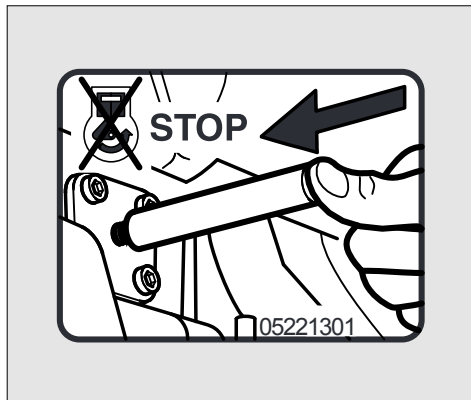

18

– Press the stop pin „2“ until the engine cuts out (see also Fig. 17, pos. 2).

– Once the engine has cut out, release the pin „2“ and ensure that it returns to its initial position, Fig. 17.

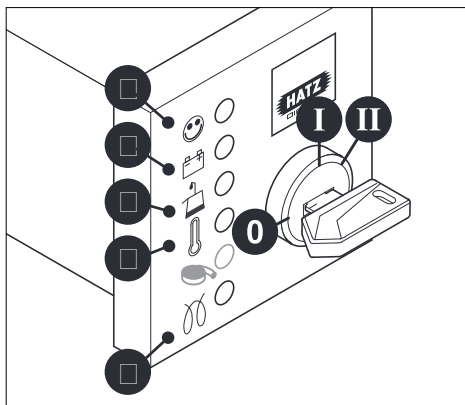

19

Depending upon the model, the battery charge indicator „2“ and oil pressure warning indicator „3“ will come on again after the engine comes to a stop.

– Turn the key to position 0 and remove it.  
All the indicator lights must go out.

**Note:**

Failure to return the starter key to position 0 may result in the battery being totally discharged.



If operation of the engine is interrupted for any reason, or at the end of the working day, the starter key should be kept out of reach of unauthorised persons.

## 5. Maintenance



Only carry out maintenance work with the engine switched off.

Observe all relevant laws and regulations governing the handling and disposal of used oil, filters and cleaning agents.

Protect the starting key against unauthorised use.

On engines with an electric starter, disconnect the battery's negative terminal.

When maintenance work has been completed, check that all tools have been removed from the engine and all protective guards fitted again.

Before starting the engine, ensure that there are no persons in the danger area close to the engine or equipment.

### 5.1. Maintenance chart

	Maintenance interval	Maintenance work required	Chap.
	Every 8 – 15 operating hours, or before each daily start-up	Check oil level.	5.2.1.
		Check combustion and cooling air intake zone.	5.2.2.
		Check air-cleaner maintenance indicator.	5.2.3.
	Every 250 operating hours	Change engine oil.	5.3.1.
		Check and adjust valve clearances. (Not applicable with automatic self adjusting valve clearance models, see next page)	5.3.2.
		Clean cooling air area.	5.3.3.
		Check screw connections.	5.3.4.
		Clean mesh insert for exhaust.	5.3.5.
	Every 500 operating hours	Change fuel filter element.	5.4.1.
		Dry-type air cleaner maintenance.	5.4.2.
	Every 1000 operating hours	Clean the oil filter.	5.5.1.
	Once a year	Siphon water out of fuel tank.	5.6.1.

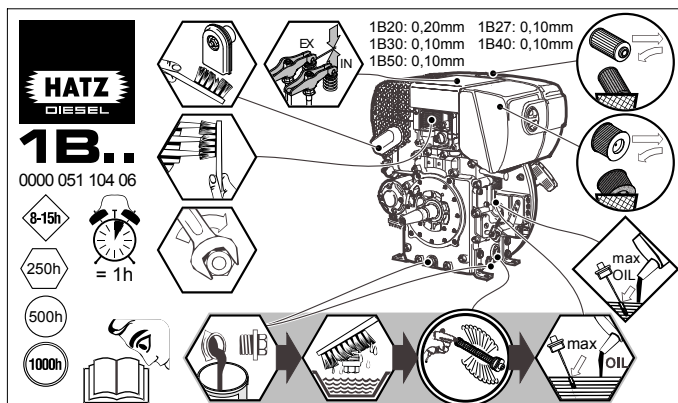

Model without automatic valve clearance adjustment.

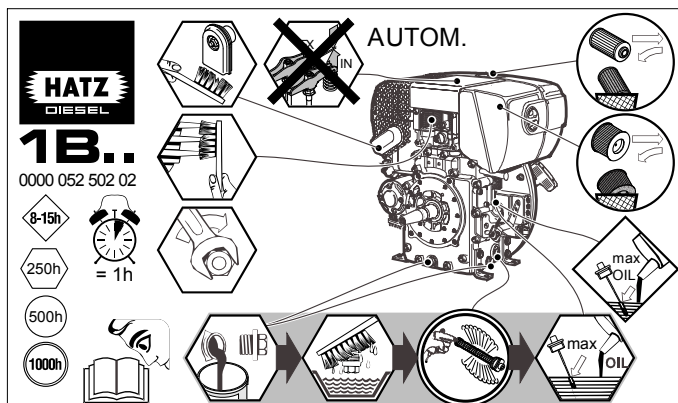

Model with automatic valve clearance adjustment.

Depending whether the engine is equipped with or without automatic valve clearance adjustment one of the illustrated maintenance plans is included. This label should be affixed to the engine or equipment in an easily visible position. The maintenance chart governs the maintenance intervals.

On new or reconditioned engines, after the first 25 operating hours, always

- Change engine oil, Chapter 5.3.1.
- Check valve clearances and adjust if necessary, Chapter 5.3.2.
- Examine screw connections, chapter 5.3.4.  
Do not tighten the cylinder head fastening.

If the engine is not used frequently, change the engine oil after 12 months at the latest, regardless of the actual number of hours it has been in operation.

## 5.2. Maintenance every 8 – 15 operating hours

### 5.2.1. Checking engine oil level

To check the oil level, the engine must be standing level and be switched off.

- Remove any dirt from the oil dipstick area.

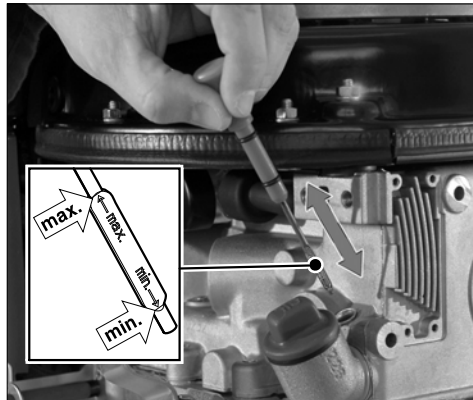

20

- For oil level inspection, remove the dipstick and wipe it dry using a lint-free, clean piece of cloth; then insert it to its stop and pull it out again.
- Check the dipstick oil level and, if necessary, add oil to the max. mark, Chapter 4.1.1.

#### Attention!

If the engine is operated while the oil level is below the min. mark or above the max. mark, it can cause damage to the engine.

### 5.2.2. Check air intake area for combustion and cooling

Heavy contamination is an indication that increased dust accumulation necessitates a correspondingly shorter maintenance interval, Chapter 5.3.3. and 5.4.2.



21

- Check air intake points „1“ for severe blockage due to leaves, heavy dust accumulation etc., and if necessary clean them.

### 5.2.3. Check air cleaner maintenance indicator (optional extra)

Mechanical service indicator

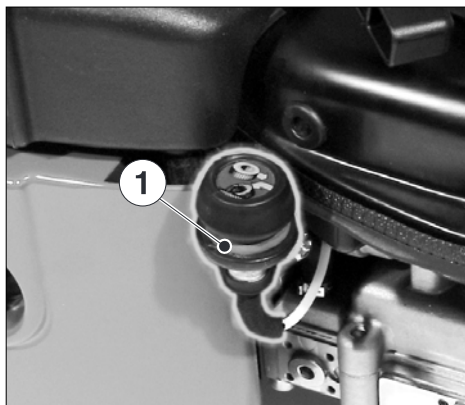

22

- Increase the speed of the engine briefly to the maximum. If the rubber bellows shrinks and covers the green area „1“, the air cleaner system should be serviced, Chapter 5.4.2. Under dusty conditions, check the rubber bellows several times per day.

### 5.3. Maintenance every 250 operating hours

#### 5.3.1. Changing engine oil

The engine must be standing level and be switched off.  
Only change the oil when the engine is warm.



Danger of scalding from hot oil !  
Trap the old oil and dispose of it in accordance with local legislation.

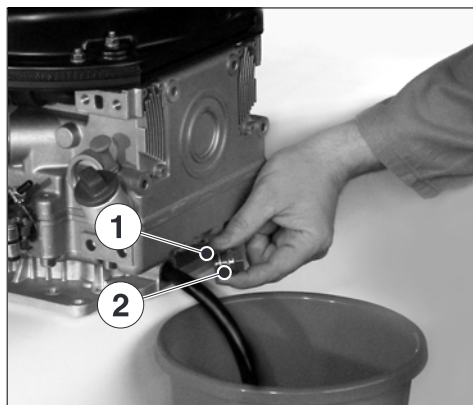

23

- Take out oil drain plug „1“ and allow the oil to drain out.
- Clean the oil drain plug „1“, fit a new washer „2“, insert and tighten.
- Add engine oil, Chapter 4.1.1.

#### 5.3.2. Checking and adjusting valve clearances

Remark:

Following steps are inapplicable in case equipment is with automatic tappet clearance compensation. Identification characteristic is maintenance plan, chapter 5.1.

Only carry out adjustments when the engine is cold (10 - 30 °C).

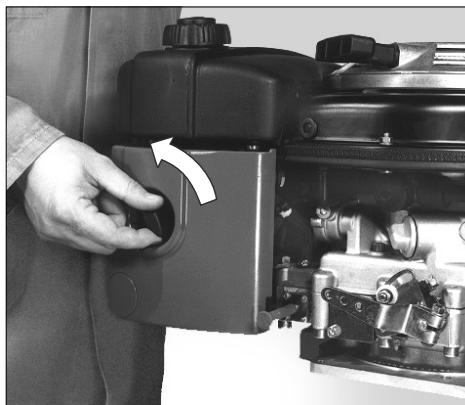

24

- Remove air cleaner cover.



25

- Remove noise insulating hood.

- Remove any contamination adhering to the cover for the cylinder head.

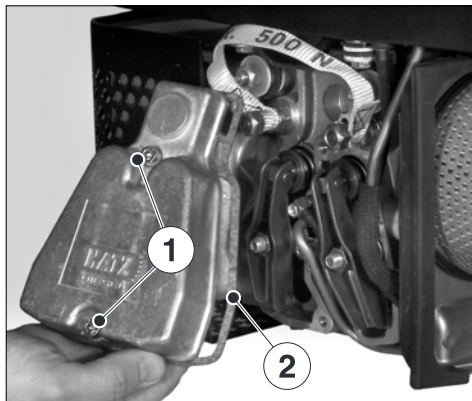

26

- Remove screws „1“ and take off the cylinder head cover with gasket „2“.



27

- Remove rubber cap from the inspection hole cover.
- Turn the engine over in the normal direction of rotation until the valves are in the overlap position (exhaust valve not yet closed, inlet valve starts to open).

- Turn the crankshaft through 360° in the normal direction of rotation and align exactly to the OT-marking, Figure 27.

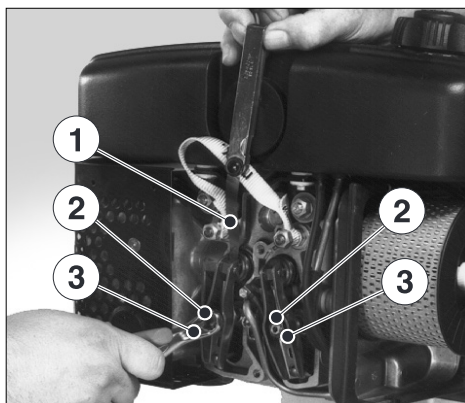

28

- Check valve clearances with feeler gauge „1“.  
For the setting, refer to Chapter 3.1.
- If valve clearances require adjusting, slacken off screw „2“ and turn hex nut „3“ until feeler gauge „1“ can be pulled through with just slight resistance when screw „2“ is retightened.
- Fit cover for cylinder head and tighten evenly, always using a new gasket.
- Re-attach parts previously removed from engine.  
Do not forget: replace the rubber cap at the inspection hole cover.
- Carry out a brief test run, then check the cover for leaks.

### 5.3.3. Cleaning cooling air area



The engine must be switched off and cooled down before cleaning!

- If severely contaminated, clean the cooling fins on the cylinder and cylinder head, and also the fan blades in the flywheel. If necessary, contact your local HATZ service station.

### 5.3.4. Checking screw connections

- Check the tightness of all threaded connections and take up slack if necessary, provided that these can be reached during maintenance work.  
Do not tighten the cylinder head bolts.

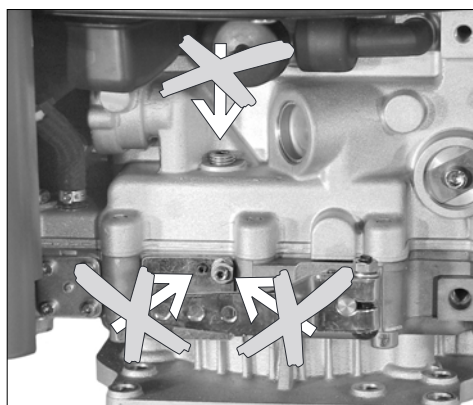

29



The adjusting screws at the engine governor and on the injection system are sealed with lacquer and are not to be tightened or adjusted.

### 5.3.5. Cleaning the exhaust mesh inlet



Exhaust system components will naturally be hot and must not be touched while the engine is running or until it has cooled down after being stopped.



30

- Release hex. nut and remove exhaust manifold.

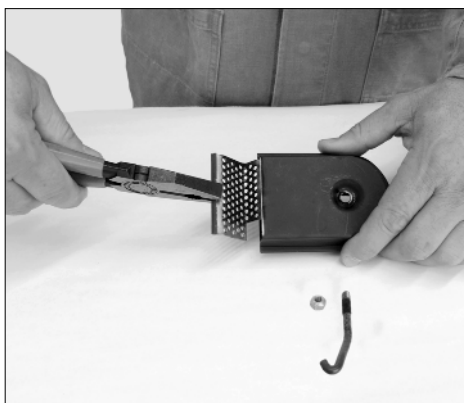

31

- Remove hex. nut and clip, then pull strainer insert out.



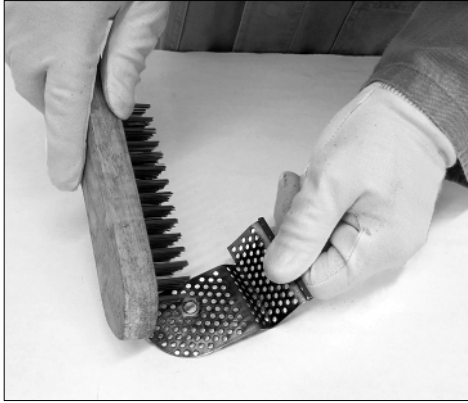

32



Risk of injury!  
Wear protective gloves.

- Eliminate deposited matter from the strainer insert using a suitable steel brush.
- Subsequently, check the strainer insert for cracks or breaks; if necessary, replace.
- Remount the strainer insert and the clip.

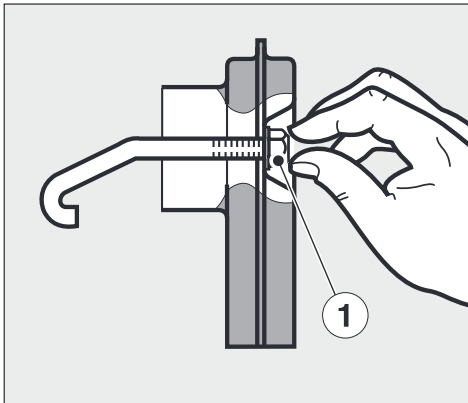

33

- Screw on hexagon nut „1“ by approx. 1 turn.

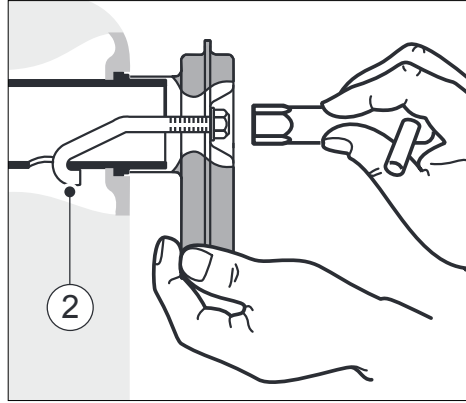

34

- Insert exhaust manifold with hoop „2“ into hole, then pull outwards again so that the hoop is retained.
- Tighten the hexagon nut fully.



## 5.4. Maintenance every 500 operating hours

### 5.4.1. Renewing fuel filter

The maintenance intervals for the fuel pump filter are dependent upon the purity of the diesel oil being used and, if necessary, may have to be reduced to 250 hours.



When working on the fuel system, do not expose it to naked flames; do not smoke.

#### Important !

Keep the entire area clean so that no dirt reaches the fuel. Fuel particles may damage the injection system.



35

- Open tank cap and pull out fuel filter from tank with cord.



36

- Pull fuel supply line „1“ off fuel filter „2“ and insert new filter.
- Fit the fuel filter again and close the tank cap. Bleeding of the fuel injection system takes place automatically.

### 5.4.2. Air cleaner maintenance

The filter cartridge should only be cleaned when the maintenance lamp lights at maximum speed, chap. 5.2.3.

However, the filter cartridge should always be replaced after 500 operating hours at the latest.

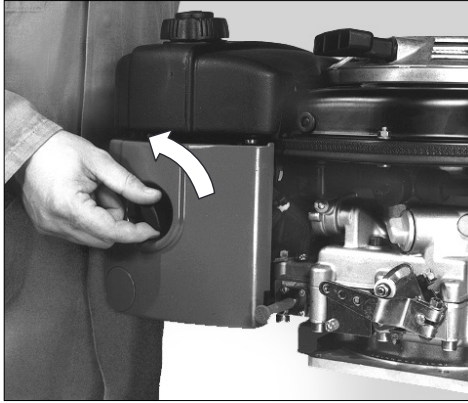

37

- Remove the air cleaner cover.

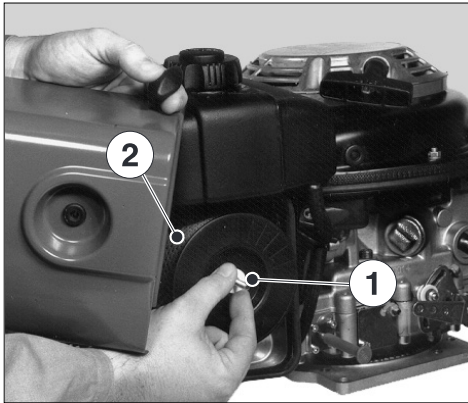

38

- Unscrew and remove knurled nut „1“ and take off air cleaner element „2“.
- Clean the filter compartment and the cover. Dirt and other foreign bodies must not be allowed to enter the engine's air inlet points.

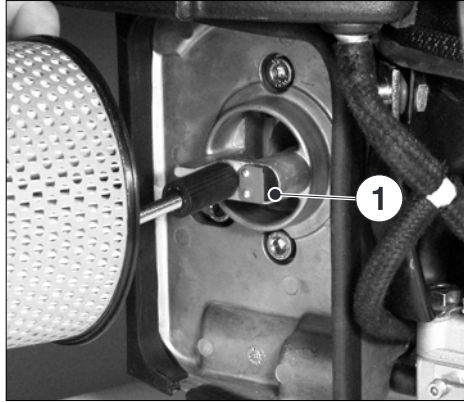

39

- On versions with a mechanical air cleaner service indicator, check the condition and cleanliness of valve plate „1“.
- The filter cartridge should either be renewed or, depending upon the degree of contamination, cleaned, or checked, as follows:

### Cleaning the filter cartridge

#### Dry contamination

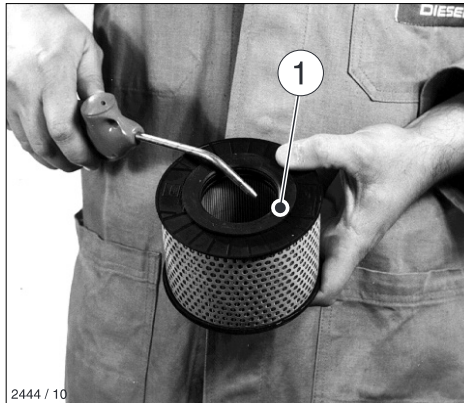

2444 / 10

40

- Use compressed air to blow through the filter cartridge from the inside outwards, until no further dirt emerges.

**Important!**

The pressure must not exceed 5 bar.

 Persons handling compressed air must wear protective goggles. Never direct the jet to animals, persons or yourself!

Moist or oily contamination  
Renew the filter cartridge.

**Checking the filter cartridge**

- Check filter cartridge's gasket surface „1“ for damage, Fig. 40.
- Check the filter cartridge for cracks or any other type of damage to the paper filter by holding it inclined towards the light or by shining a light source through it.

**Important!**

The slightest damage to the paper filter rules out it being used any longer.

- Re-assemble the filter cartridge in the reverse order of work.

**5.5. Maintenance every 1000 operating hours**

**5.5.1. Cleaning the oil filter**

Cleaning of oil filter should be carried out together with changing engine oil.

The engine must be standing level and be switched off.

 Danger of scalding from hot oil!  
Trap the old oil and dispose of it in accordance with local legislation.

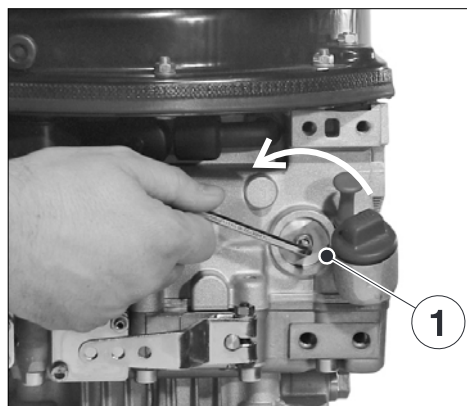

41

- Loosen screw „1“ with approx. 5 rotations.

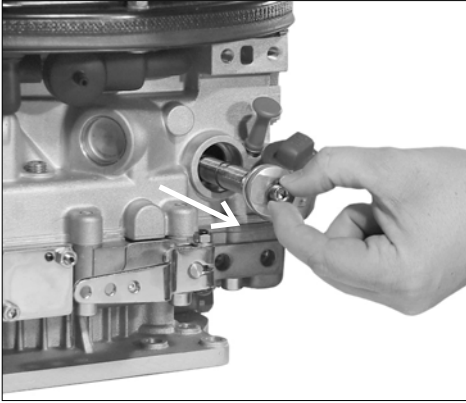

42

- Remove oil filter from housing.



43

- Use an air line to blow out oil filter dirt from the inside outwards.

 Persons handling compressed air must wear protective goggles. Never direct the jet to animals, persons or yourself!

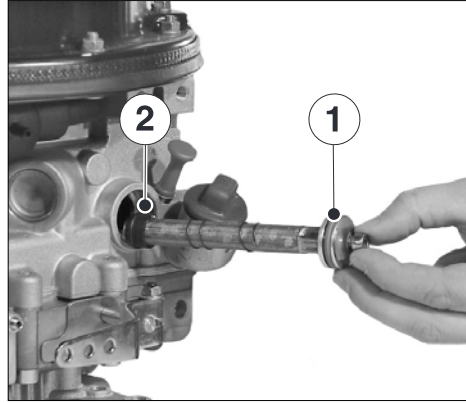

44

- Check joint washer „1“ whether it is damage; replacement if necessary.
- Coat packing rings „1“ and „2“ slightly with oil before assembly.

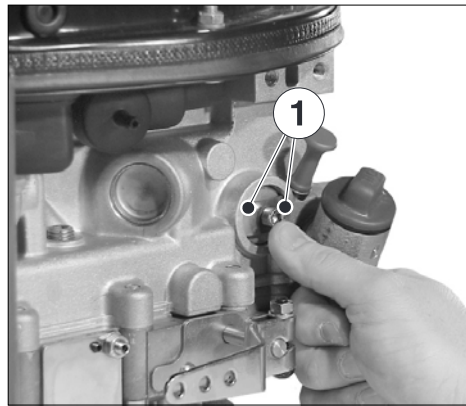

45

- Put in oil filter and press until limit stop.
- Check whether tension springs sit close to oil filter with both ends „1“, before tightening screw.
- Check the dipstick oil level and, if necessary, add oil to the max. mark, Chapter 4.1.1.

## 5.6. Servicing: once a year

### 5.6.1. Draining the fuel tank



When working on the fuel system, do not expose it to a naked flame; do not smoke.

- Condensation forms due to temperature variations at the lowest points of the fuel tank.

The condensate must therefore be removed once a year as follows:

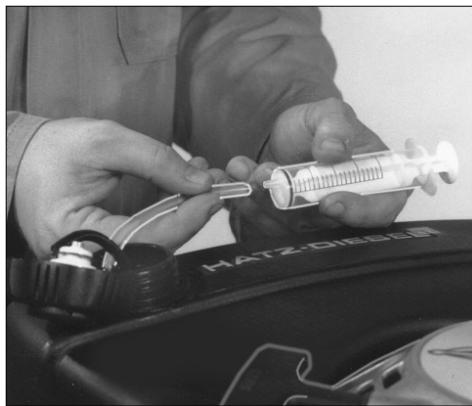

46

- Fit a polyethylene tube ( diameter 4 mm, length approx. 350 mm) to a commercial syringe (20 ml or larger).



47

- Run the tube down to the bottom of the tank and drain off the diesel oil/water mixture. The specific gravity of water is heavier than that of diesel oil and therefore a distinct dividing line should be visible.
- Repeat the procedure several times until the transparent syringe is full of diesel oil only.

## 6. Malfunctions – causes and remedies

Malfunctions	Possible causes	Remedy	Chap.
6.1. Engine does not start, or not immediately, but can be turned over easily as usual.	Speed control lever in stop or idle position.	Move lever to START position.	4.2.1.
	Engine shutdown pin in STOP position.	Move to operating position by pulling the pin gently.	4.3.
	No fuel in the injection pump.	Add fuel. Systematically check the entire fuel supply system: If still no fault found, - check engine feed line - check fuel filter	4.1.2. 5.4.1.
	Insufficient compression: - Incorrect valve clearance.	Check valve clearances, adjust if necessary.	5.3.2.
	- Cylinders and/or piston rings worn.	See workshop manual.	
	Injector not functioning.	See workshop manual.	
At low temperatures.	Below starting threshold temperature.	Operate preheater (optional extra).	4.2.4.
	Equipment not disengaged.	Disengage engine from equipment, if possible.	
	Preheating system faulty (optional extra).	See workshop manual.	
	Fuel has inadequate resistance to low temperatures.	Check whether clear (not turbid) fuel emerges at the fuel line detached from the injection pump. If turbid or separated - either warm up the engine or drain the complete fuel supply system. Refill with winter-grade fuel to which paraffin has been added.	4.1.2.

Malfunctions	Possible causes	Remedy	Chap.
At low temperatures	Starting speed below 400 rpm: - Viscosity of oil too high.	Change lubricating oil and add oil of the correct viscosity class.	5.3.1. 4.1.1.
	- Battery charge too low.	Check the battery, if necessary contact a service station.	7.
If equipped with a stop solenoid or automatic electrical shutdown system (additional equipment)	Solenoid faulty and/or fault in the electrical system.	See workshop manual.	
6.2. Engine fires but does not run.	Speed control lever not moved far enough towards „START“.	Move lever to „START“ position.	4.2.1.
	Equipment not disengaged.	Disengage engine from equipment if possible.	
	Fuel filter blocked.	Renew fuel filter.	5.4.1.
With automatic shutdown (optional extra)	One of the automatic shutdown's monitoring elements has initiated a stop signal. (See also Chapter 6.4.).	Localise the monitoring element responsible and clear the fault, or contact a HATZ service station.	
6.3. Starter motor does not operate or engine does not turn over.	Fault in the electrical system:		
	- Battery and/or other cables incorrectly connected up. - Cable connections loose and/or oxidised. - Battery faulty and/or flat. - Starter motor faulty. - Faulty relays, monitoring element.	Check electrical system and its component. See also the workshop manual.	7.

Malfunctions	Possible causes	Remedy	Chap.
6.4. Engine cuts out of its own accord during operation.	Fuel supply interrupted - Tank has run empty. - Fuel filter blocked. - Aeration outlet restricted at fuel tank seal. - Air in the fuel system.	Add fuel. Change fuel filter.  Ensure adequate tank venting. Check fuel system for penetration of air. Check air vent valve.	4.1.2. 5.4.1.
	Mechanical faults.	Contact a HATZ service station.	
With automatic electrical shut-down installed (optional extra)	One of the automatic shut-down's monitoring elements has initiated a stop signal.  Monitoring element for: - oil pressure too low  - engine temperature too high  - defective alternator.  Malfunction signal from over-voltage and polarity reversal protection in voltage regulator: - Battery and/or other cable connections incorrectly connected. - Cable connections loose.	Localise the monitoring element responsible and clear the fault, or contact a HATZ service station.  Check oil lubrication.  Check air cooling zone for contamination. See workshop manual.  Check electrical equipment and the components thereof.	 5.2.1.  5.3.3.
6.5. Engine output and speed both drop.	Fuel supply interrupted: - Tank has run empty. - Fuel filter blocked. - Aeration outlet restricted at fuel tank seal. - Air in the fuel system.  - Speed control lever does not remain in desired position.	Add fuel. Change fuel filter.  Provide adequate tank breathing. Check fuel system for penetration of air. Check air vent valve.  Lock the lever into position.	4.1.2. 5.4.1.



Malfunctions	Possible causes	Remedy	Chap.
6.6. Engine output and speed fall, black smoke from exhaust.	Air cleaner contaminated.	Clean or renew the air cleaner.	5.4.2.
	Valve clearances incorrect.	Adjust valve clearances.	5.3.2.
	Injector not functioning.	See workshop manual.	
6.7. Engine becomes very hot. Indicator lamp for cylinder temperature (optional extra) comes on.	Too much lubricating oil in engine.	Drain off lubricating oil as far as upper mark on dipstick.	5.3.1.
	Inadequate cooling: - Contamination of entire cooling air zone.	Clean cooling air zone.	5.3.3.
	- Air duct panels not properly sealed.	Check cooling air deflector plates and shafts for completeness and airtight seal.	
6.8. Condensate outlet from exhaust box.	Operation over a longer period without load.	Run engine with a load of 70% until the exhaust box gets dry again.	

## 7. Work on the electrical system



Batteries generate explosive gases. Keep them away from naked flame and sparks which could cause them to ignite. Do not smoke.

Protect eyes, skin and cloth against the corrosive battery acid. Pour clear water over acid splashes immediately. In case of emergency call doctor.

Do not place any tools on top of the battery. Always disconnect the negative (–) pole of the battery before working on the electric device.

- Do not confuse the positive (+) and negative (–) terminals of the battery.
- When fitting the battery, first connect up the positive lead, then the negative lead.  
Negative terminal to earth = engine block.
- When removing, first disconnect the negative lead, then the positive lead.
- Always take care to avoid short-circuits and earth (ground) contact of live cables.
- If malfunctions occur, first of all check that cable connections make good contact.
- Replace a failed indicator light without delay.
- Do not remove the ignition key while the engine is running.
- Do not disconnect the battery while the engine is running. Electric voltage peaks can cause damage to electrical components.
- In case of an emergency start in manual mode, leave the battery (which might be discharged) connected to the engine.
- For emergency operation without battery, make sure that the plug-and-socket connector to the instrument box is disconnected additionally before the engine is started.

- Do not splash electrical device with water jet or pressure jet during engine cleaning.
- When carrying out welding work on the engine or equipment, fit the earth clip of the welding equipment as close to the welding point as possible and disconnect the battery. The connecting plug for the voltage regulator must be removed.

The relevant circuit diagrams are enclosed with the engine if it is equipped with an electrical system. Additional circuit diagrams can be supplied to order.

HATZ assumes no liability for electrical systems which was not carried out acc. HATZ circuit diagrams.

## 8. Storage out of use

The new engine can normally be stored dry for up to one year.

In very humid climates or coastal regions, the protective treatment is sufficient for up to about 6 months.

For longer periods of storage, please contact your nearest HATZ service station.



## Extended manufacturer's declaration / Declaration of Incorporation EC Machinery Directive 98/37/EC or 2006/42/EC\*)

The manufacturer: **Motorenfabrik Hatz GmbH & Co.KG**  
**Ernst-Hatz-Straße 16**  
**D-94099 Ruhstorf a. d. Rott**

hereby declares that the incomplete machine: product description: **Hatz diesel engine**

Type designation and as of serial number:

**1B20=10031; 1B20 NON EPA=30031; 1B20V=11121; 1B20V NON EPA=30121; 1B20R=14410;**  
**1B27=12510; 1B27 NON EPA=30810;**  
**1B30=10125; 1B30 NON EPA=30225; 1B30V=11216; 1B30V NON EPA=30316;**  
**1B40=11014; 1B40 NON EPA=30414; 1B40V=11714; 1B40V NON EPA=30514;**  
**1B50=12411; 1B50 NON EPA=30611; 1B50V=12611; 1B50V NON EPA=30711**

satisfies the following basic safety and health protection requirements in acc. with Annex I to the above-mentioned Directive.

- Annex I, General principles no. 1

- Nr. 1.1.2., 1.1.3., 1.1.5., 1.2.1., 1.2.2., 1.2.3., 1.2.4.1., 1.2.4.2., 1.3.1., 1.3.2., 1.3.3., 1.3.4., 1.3.7., 1.3.9., 1.4.1., 1.5.1., 1.5.3., 1.5.8., 1.5.9., 1.6.1., 1.6.2., 1.6.4., 1.7.

All relevant basic safety and health protection requirements down to the interfaces described

☒ in the operating manual

☒ in the enclosed data sheets

☒ in the enclosed technical documents

have been complied with.

The special technical documents in acc. with Annex VII B of the Directive 2006/42/EC have been prepared \*\*).

Conformity with the provisions of the following, other EC Directives, i.e.

- **2004/108/EG Electromagnetic Compatibility (EMC)**, dated 15.12.2004

The following standards have been used (completely or partially):

- EN 1679-1: 051998      - EN ISO 12100-1: 042004      - EN ISO 13857: 062008  
- EN ISO 14121-1: 122007      - EN ISO 12100-2: 042004

I will submit the above-mentioned specific technical documents electronically to the competent government authority, if applicable\*\*)

The Operating Manual has been enclosed to the incomplete machine and the Assembly Instructions have been provided to the customer electronically together with the order confirmation.

Commissioning has been prohibited until it has been established, if applicable, that the machine into which the above-mentioned incomplete machine is to be incorporated, satisfies the provisions of the Machinery Directive.

Wolfgang Krautloher / see "Manufacturer"  
Name / address of EC documentation officer \*\*)

29/10/2009

Krautloher / Directives official

Date

Signature and information on the undersigned

  
Signature

\*) The machine satisfies the substantial requirements of both directives  
98/37/EC shall apply until 28.12.2009; 2006/42/EC shall apply as of 29.12.2009

\*\*) applies only to the Directive 2006/42/EC

**CALIFORNIA**

**Proposition 65 Warning**

Diesel engine exhaust and some of its constituents are known to the State of California to cause cancer, birth defects, and other reproductive harm.



# Technical Library

<http://engine.od.ua>

