

# **OPERATION MANUAL**

**WHEEL EXCAVATOR  
R170W-7A**

# **HYUNDAI**

# CONTENTS

Foreword .....	0-1	7. Efficient working method .....	4-18
Before servicing this machine .....	0-2	8. Operation in the special work sites .....	4-23
EC regulation approved .....	0-3	9. Normal operation of excavator .....	4-25
Table to enter S/No and distribution .....	0-4	10. Attachment lowering .....	4-26
Safety labels .....	0-5	11. Storage .....	4-27
Machine data plate .....	0-16	12. RCV lever operating pattern .....	4-29
Guide(Direction, S/No, Symbol) .....	0-17	13. Switching hydraulic attachment circuit .....	4-31

## SAFETY HINTS

1. Before operating the machine .....	1-1
2. During operating the machine .....	1-6
3. During maintenance .....	1-13
4. Parking .....	1-16

## SPECIFICATIONS

1. Major components .....	2-1
2. Specifications .....	2-2
3. Working range .....	2-4
4. Weight .....	2-6
5. Lifting capacities .....	2-7
6. Bucket selection guide .....	2-10
7. Specification for major components .....	2-11
8. Recommended oils .....	2-15

## CONTROL DEVICES

1. Cab devices .....	3-1
2. Cluster .....	3-2
3. Switches .....	3-13
4. Levers and pedals .....	3-22
5. Air conditioner and heater .....	3-25
6. Others .....	3-32

## OPERATION

1. Suggestion for new machine .....	4-1
2. Check before starting the engine .....	4-2
3. Starting and stop the engine .....	4-3
4. Mode selection system .....	4-6
5. Operation of the working device .....	4-11
6. Traveling of the machine .....	4-12

## TRANSPORTATION

1. Road traveling .....	5-1
2. Preparation for transportation .....	5-2
3. Dimension and weight .....	5-3
4. Loading the machine .....	5-6
5. Fixing the machine .....	5-8

## MAINTENANCE

1. Instruction .....	6-1
2. Tightening torque .....	6-6
3. Fuel, coolant and lubricants .....	6-9
4. Maintenance check list .....	6-11
5. Maintenance chart .....	6-16
6. Service instruction .....	6-18
7. Electrical system .....	6-43
8. Air conditioner and heater .....	6-46

## TROUBLESHOOTING GUIDE

1. Engine .....	7-1
2. Electrical system .....	7-2
3. Others .....	7-3

## HYDRAULIC BREAKER AND QUICK CLAMP

1. Selecting hydraulic breaker .....	8-1
2. Circuit configuration .....	8-2
3. Maintenance .....	8-3
4. Precaution while operating the breaker .....	8-4
5. Quick clamp .....	8-6

INDEX .....	9-1
-------------	-----

# SAFETY LABELS

## 1. LOCATION

Always keep these labels clean. If they are lost or damaged, attach them again or replace them with a new label.

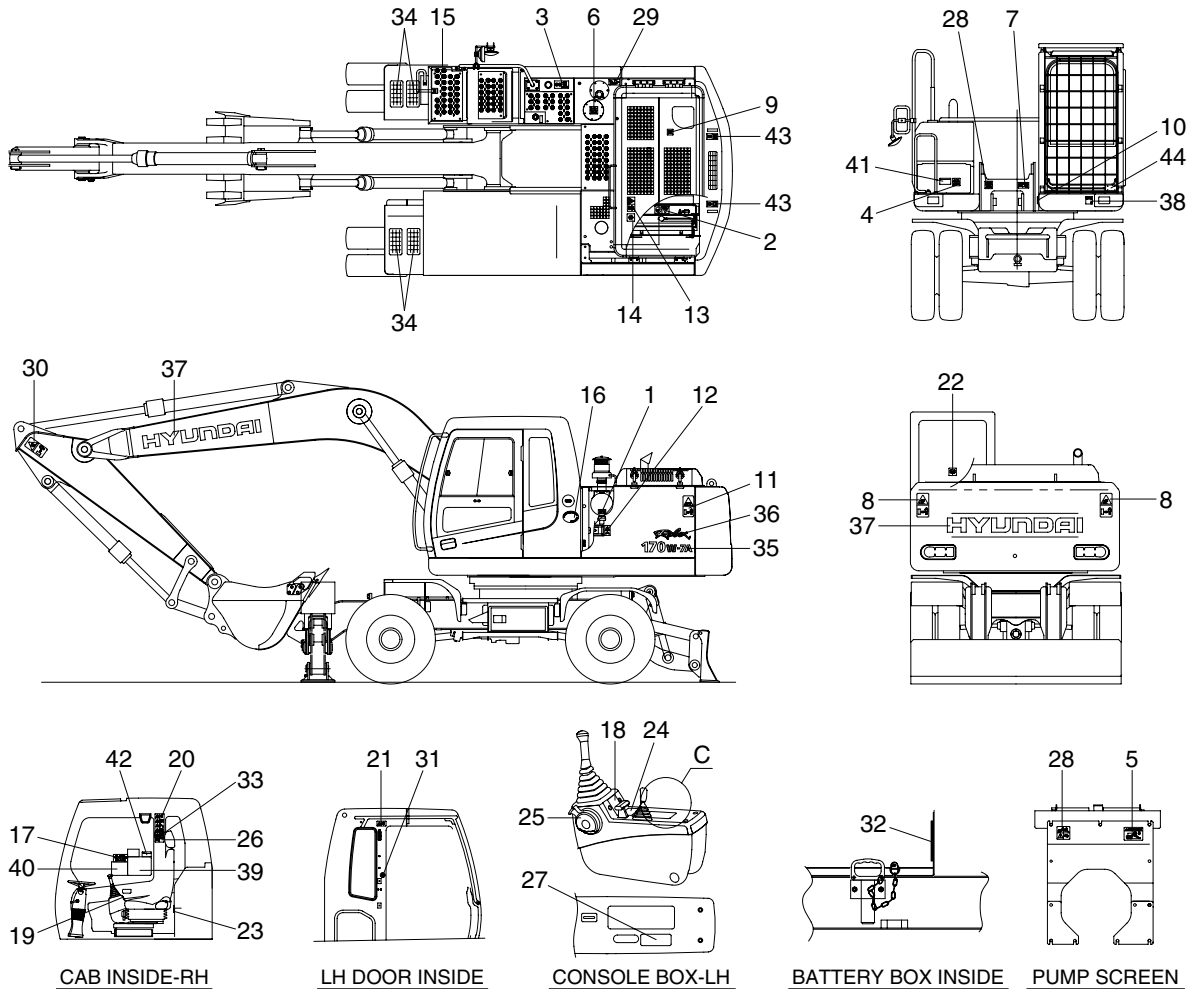

- |    |                           |    |                                    |    |                     |
|----|---------------------------|----|------------------------------------|----|---------------------|
| 1  | Air cleaner filter        | 17 | Control ideogram                   | 32 | Swing ideogram      |
| 2  | Radiator cap              | 18 | Control ideogram(LH)               | 33 | Swing lock          |
| 3  | Fueling                   | 19 | Control ideogram(RH)               | 34 | Step tread          |
| 4  | Battery accident          | 20 | Ref operator manual-cab. RH pillar | 35 | Model name          |
| 5  | Hydraulic oil level       | 21 | Safety front window                | 36 | Logo(ROBEX)         |
| 6  | Hydraulic oil lubrication | 22 | Alternate exit                     | 37 | Trade mark-Boom/CWT |
| 7  | Reduction gear grease     | 23 | Air conditioner filter             | 38 | Noise level LWA     |
| 8  | Keep clear-Rear           | 24 | Console box tilting                | 39 | Service instruction |
| 9  | Turbocharger cover        | 25 | Safety lever                       | 40 | Lifting chart       |
| 10 | Name plate                | 26 | Locking clamp                      | 41 | ECU connector       |
| 11 | Keep clear-Side           | 27 | Ideogram-dozer/outrigger           | 42 | Turbocharger        |
| 12 | Stay fix                  | 28 | High pressure hose                 | 43 | Lifting eye         |
| 13 | Shearing-engine hood      | 29 | Falling                            | 44 | FOPS-FOG plate      |
| 14 | No step engine hood       | 30 | Keep clear-Boom/Arm                |    |                     |
| 15 | Transporting              | 31 | Hammer                             |    |                     |
| 16 | Low emission engine       |    |                                    |    |                     |

17W7A0SL01

## 6) SWITCH PANEL

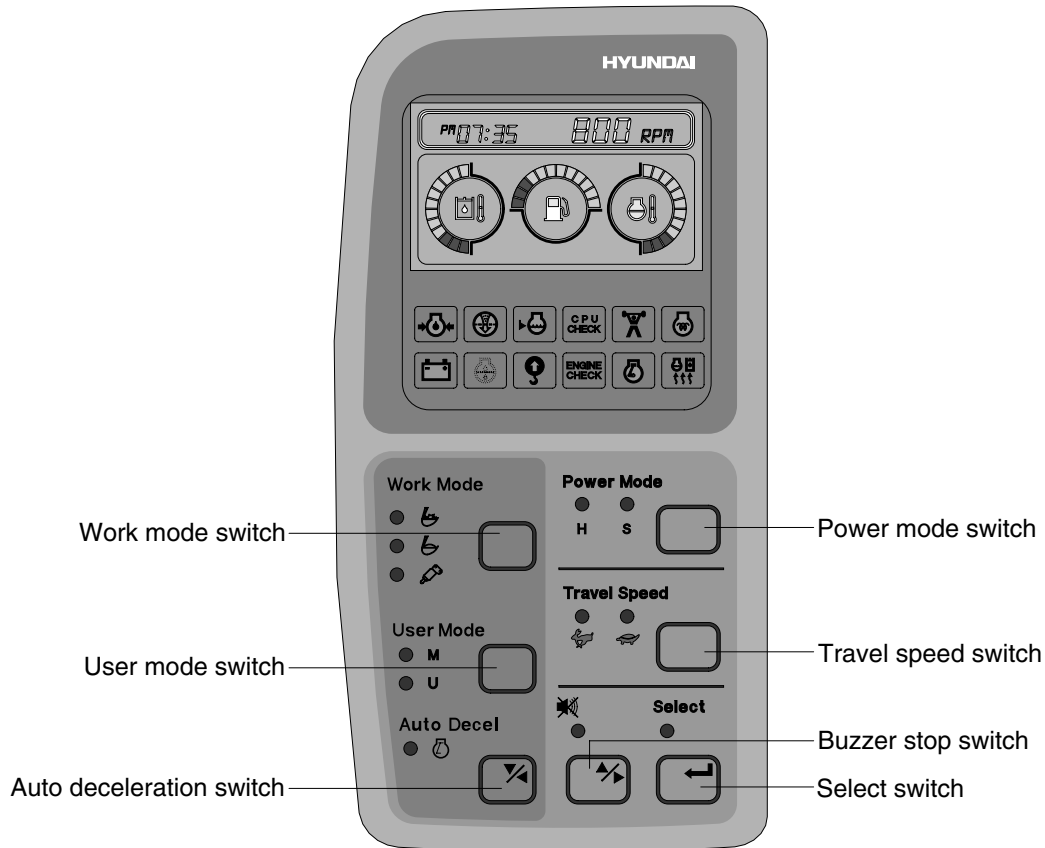

1607A3CD19

- ※ When the switches (Work mode, Power mode, Auto decel, Travel speed control) are selected, the pop-up icon is displayed on the LCD.  
Refer to the page 3-4 for details.

### (1) Work mode switch

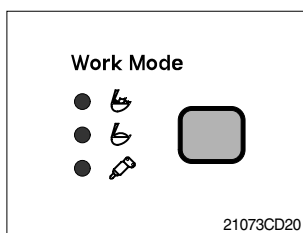

- ① This switch is to select the machine operation mode, which shifts from general operation mode to heavy operation mode and breaker mode in a row by pressing the switch.

- : Heavy duty work mode
- : General work mode
- : Breaker operation mode

※ Refer to the page 4-6 for details.

### (2) User mode switch

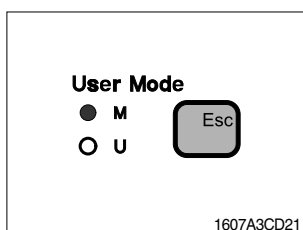

- ① This switch is to select the maximum power or user mode.

- M : Maximum power
- U : Memorizing operators preferable power setting.

※ Refer to the page 4-6 for details.

### (3) Auto deceleration switch

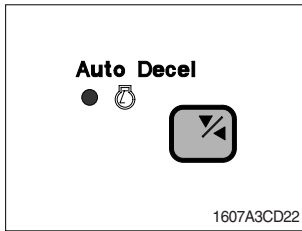

- ① This switch is used to actuate or cancel the auto deceleration function.
- ② When the switch actuated and all control levers and pedals are at neutral position, engine speed will be lowered automatically to save fuel consumption.
  - Light ON : Auto deceleration function is selected.
  - Light OFF : a. Auto deceleration function is cancelled so that the engine speed increased to previous setting value.  
b. One touch decel function is available.

### (4) Power mode switch

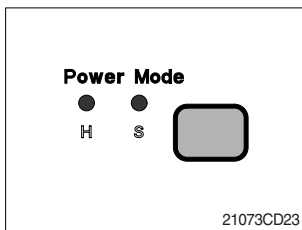

- ① The lamp of selected mode is turned ON by pressing the switch(  ).
  - H : High power work.
  - S : Standard power work.

### (5) Travel speed control switch

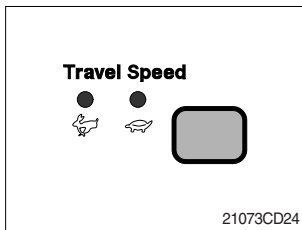

- ① This switch is to control the travel speed which is changed to high speed(Rabbit mark) by pressing the switch and low speed(Turtle mark) by pressing it again.

### (6) Buzzer stop switch

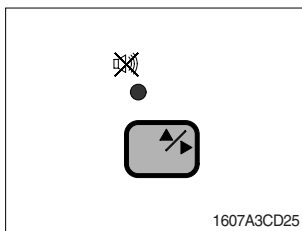

- ① When the starting switch is turned ON first, normally the alarm buzzer sounds for 2 seconds during lamp check operation.
- ② The red lamp lights ON and the buzzer sounds when the machine has a problem.  
In this case, press this switch and buzzer stops, but the red lamp lights until the problem is cleared.

### (7) Select switch

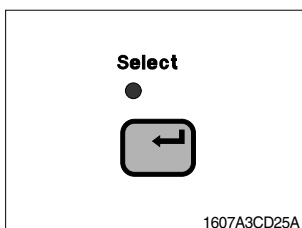

- ① This switch is used to enter main menu and sub menu of LCD.  
i Refer to the page 3-5 for details.

### 3. SWITCHES

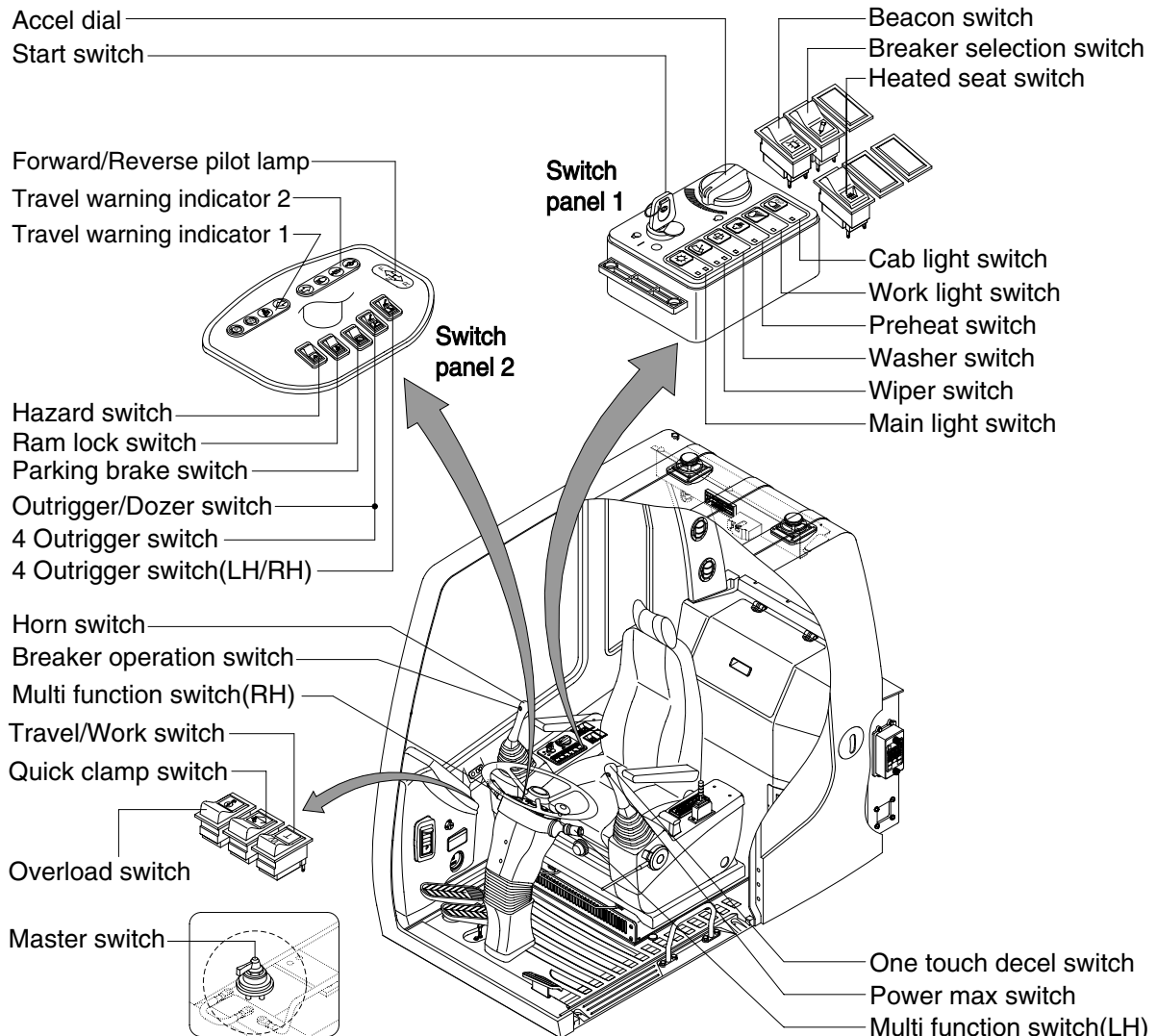

17W7A3CD26

#### 1) STARTING SWITCH

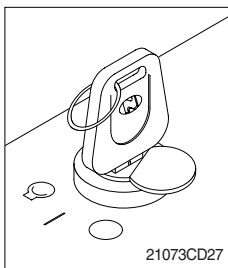

(1) There are three positions, OFF, ON and START.

- ○ (OFF) : None of electrical circuits activate.
- | (ON) : All the systems of machine operate.
- ○ (START) : Use when starting the engine.

Release key immediately after starting.

- ※ If you turn ON the starting switch in cold weather, the fuel warmer is automatically operated to heat the fuel by sensing the coolant temperature. Start the engine in 1~2 minutes after turning ON the starting switch. More time may take according to ambient temperature.
- ※ Key must be in the ON position with engine running to maintain electrical and hydraulic function and prevent serious machine damage.

## 5. MAINTENANCE CHART

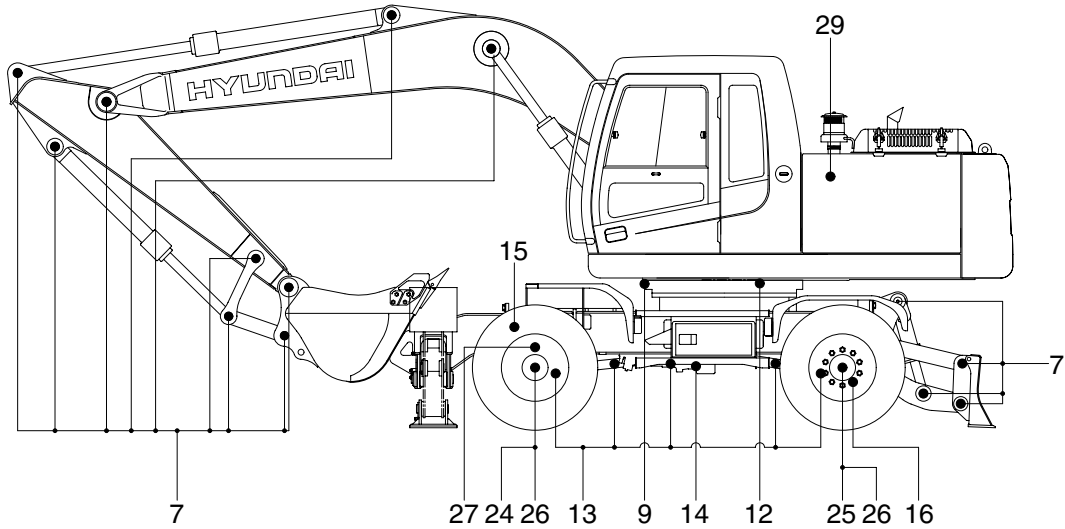
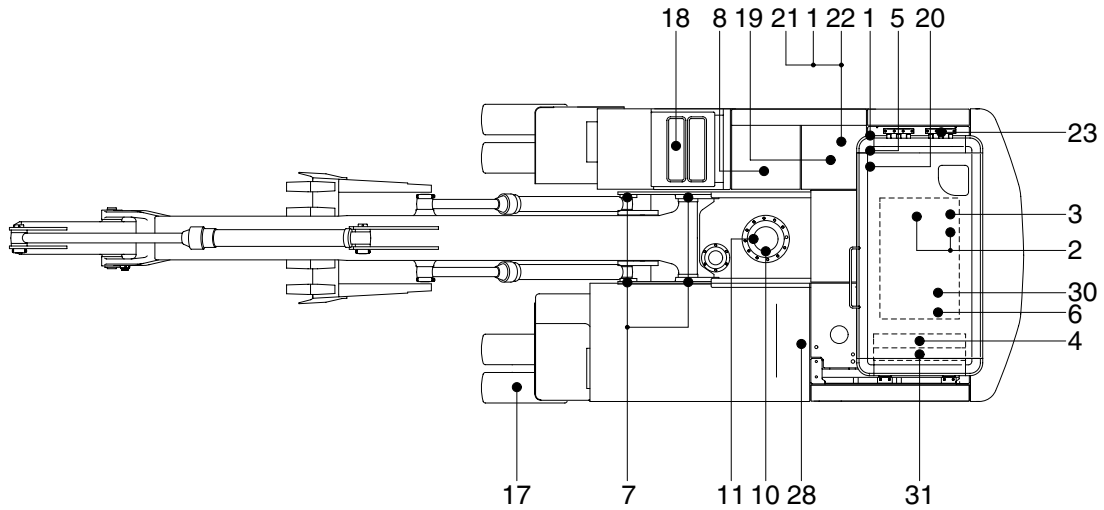

17W7A6MA05

### Caution

1. Service intervals are based on the hour meter reading.
2. The number of each item shows the lubrication point on the machine.
3. Stop engine while filling oil, and use no open flames.
4. For other details, refer to the service manual.

## 6. SERVICE INSTRUCTION

### 1) CHECK ENGINE OIL LEVEL

Check the oil level with the machine on a flat ground before starting engine.

- (1) Pull out the dipstick and wipe with a clean cloth.
  - (2) Check the oil level by inserting the dipstick completely into the hole and pulling out again.
  - (3) If oil level is LOW, add oil and then check again.
    - ※ If the oil is contaminated or diluted, change the oil regardless of the regular change interval.
    - ※ Check oil level after engine has been stopped for 15 minutes.
- ▲ Do not operate unless the oil level is in the normal range.

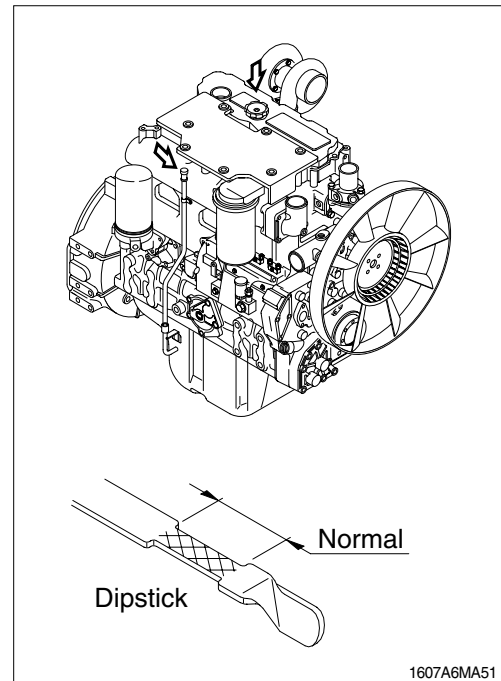

### 2) REPLACEMENT OF ENGINE OIL AND OIL FILTER

- (1) Warm up the engine.
- (2) Open the drain cock and allow the oil to drain.
  - ※ A drain pan with a capacity of 20 liters(5 U.S. gallons) will be adequate.

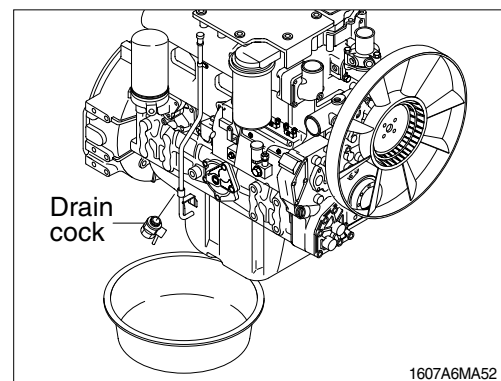

- (3) Clean around the filter head, remove the filter with a filter wrench and clean the gasket surface.

